

CF1035

**5550 MHz
LTCC Filter**

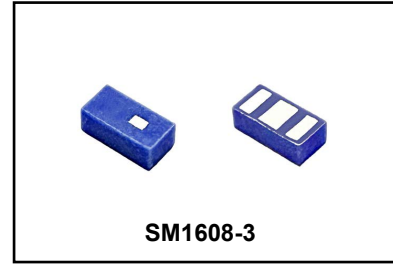

• Complies with Directive 2002/95/EC (RoHS)

Absolute Maximum Ratings

Rating	Value
Input Power	3.0 W
Operating Temperature Range	-40° to +85°C
Storage Temperature Range	-40°C to +85°C
Input/Output Impedance	50 Ω
Moisture Sensitivity Level: 1	

Electrical Characteristics

Item	Unit	Min.	Typ.	Max.	Note
Center Frequency	MHz		5550		
Insertion Loss (5150 - 5952 MHz)	@25°C		0.66	0.85	
	40~85°C			1.0	
Return Loss (5150 - 5952 MHz)	dB		17.7	12	
Attenuation (reference level from 0 dB)					
100 - 960 MHz	dB	33	43		
1166 - 1249 MHz	dB	33	41.5		
1427 - 1610 MHz	dB	33	40.6		
1695 - 2200 MHz	dB	33	39.7		
2300 - 2370 MHz	dB	33	39.7		
2400 - 2484 MHz	dB	33	40		
2496 - 2690 MHz	dB	33	40.2		
3400 - 3800 MHz	dB	30	36.7		
7250 - 7800 MHz	dB	30	30.7		
10300 - 11850 MHz	dB	25	35.9		
15450 - 17775 MHz	dB	25	28.3		

Case Style	SM1608-3, 1.6 x 0.8 mm
------------	------------------------



CAUTION: Electrostatic Sensitive Device. Observe precautions for handling.

NOTES:

1. The design, manufacturing process, and specifications of this device are subject to change.
2. US or International patents may apply.
3. This component was always RoHS compliant from the first date of manufacture.

Frequency Characteristics

S21

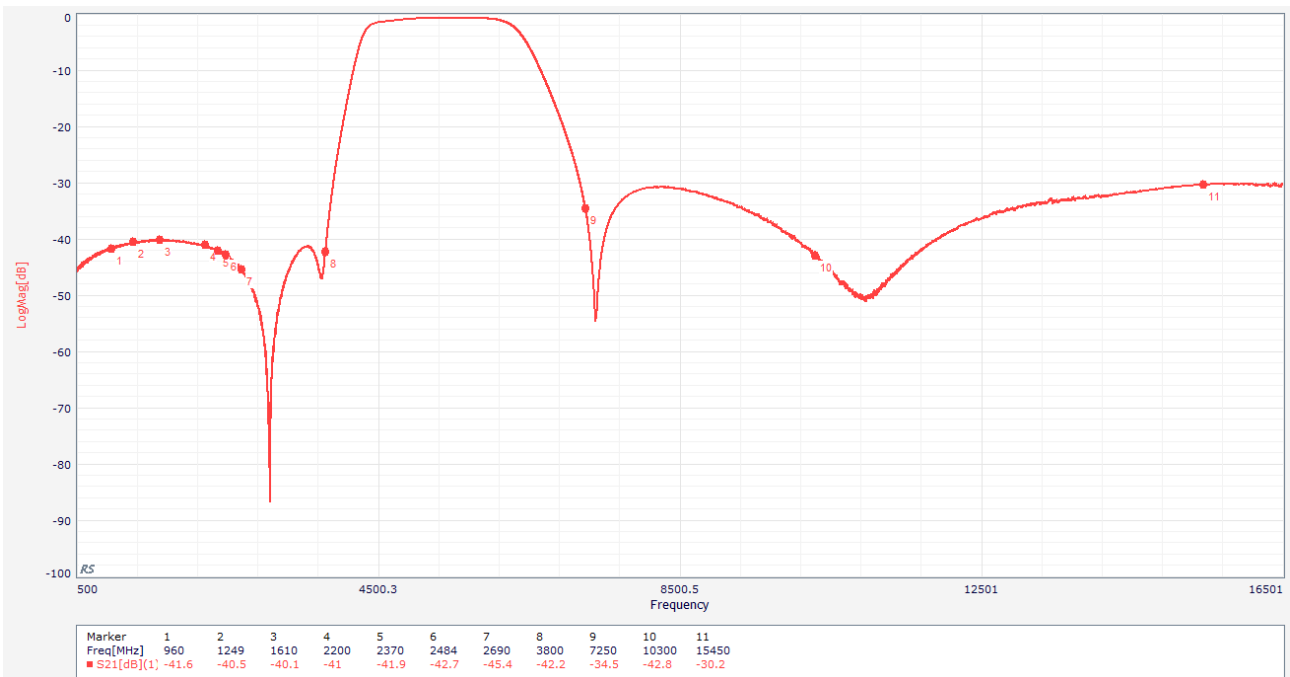
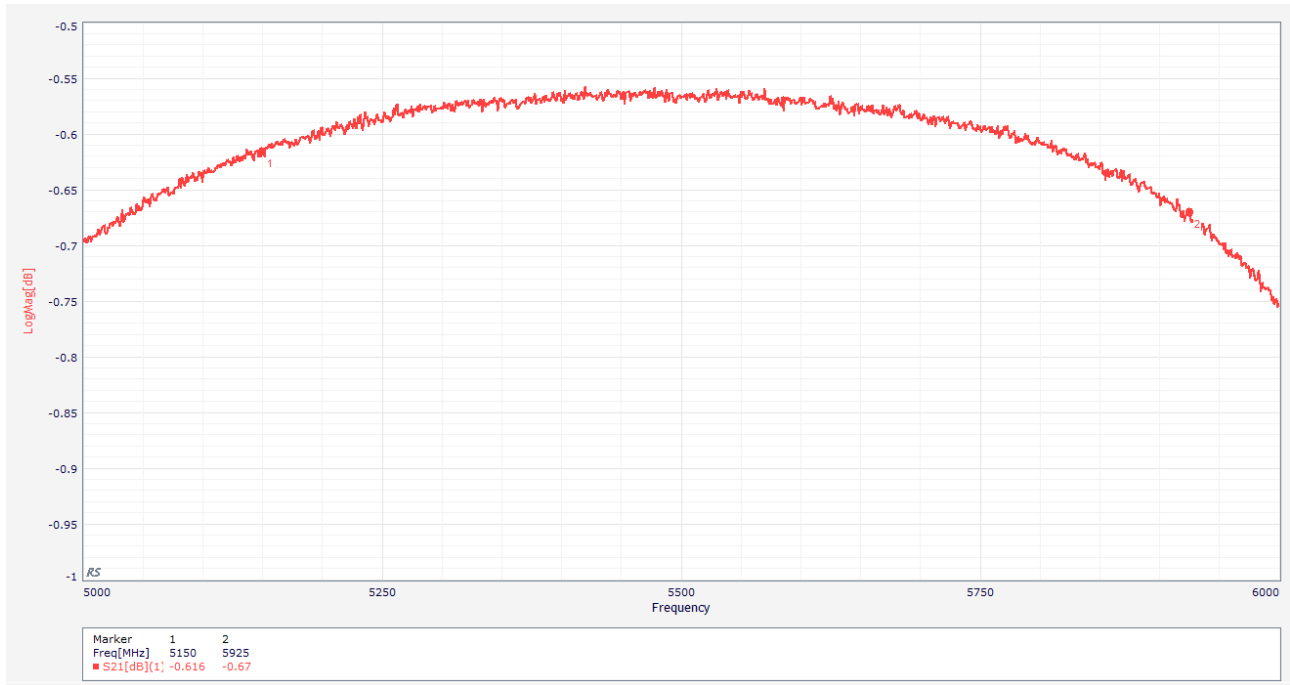

Frequency Characteristics

S11

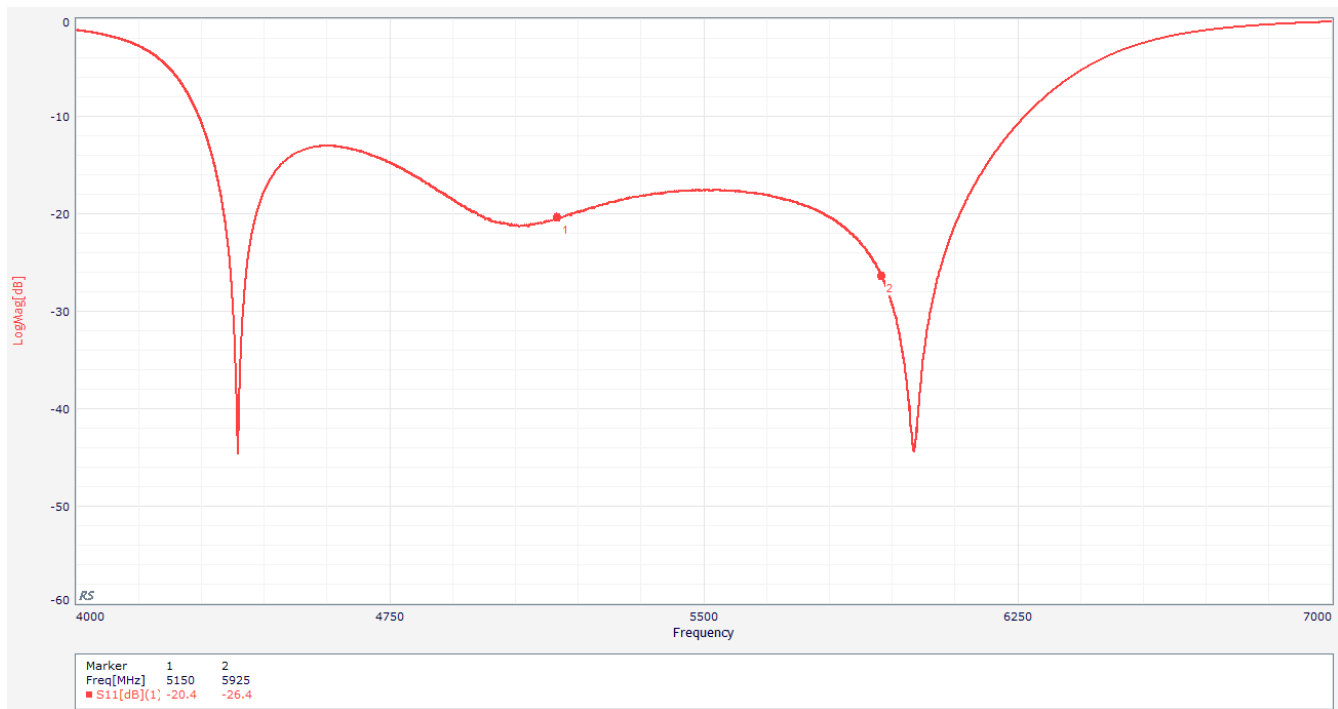

S22

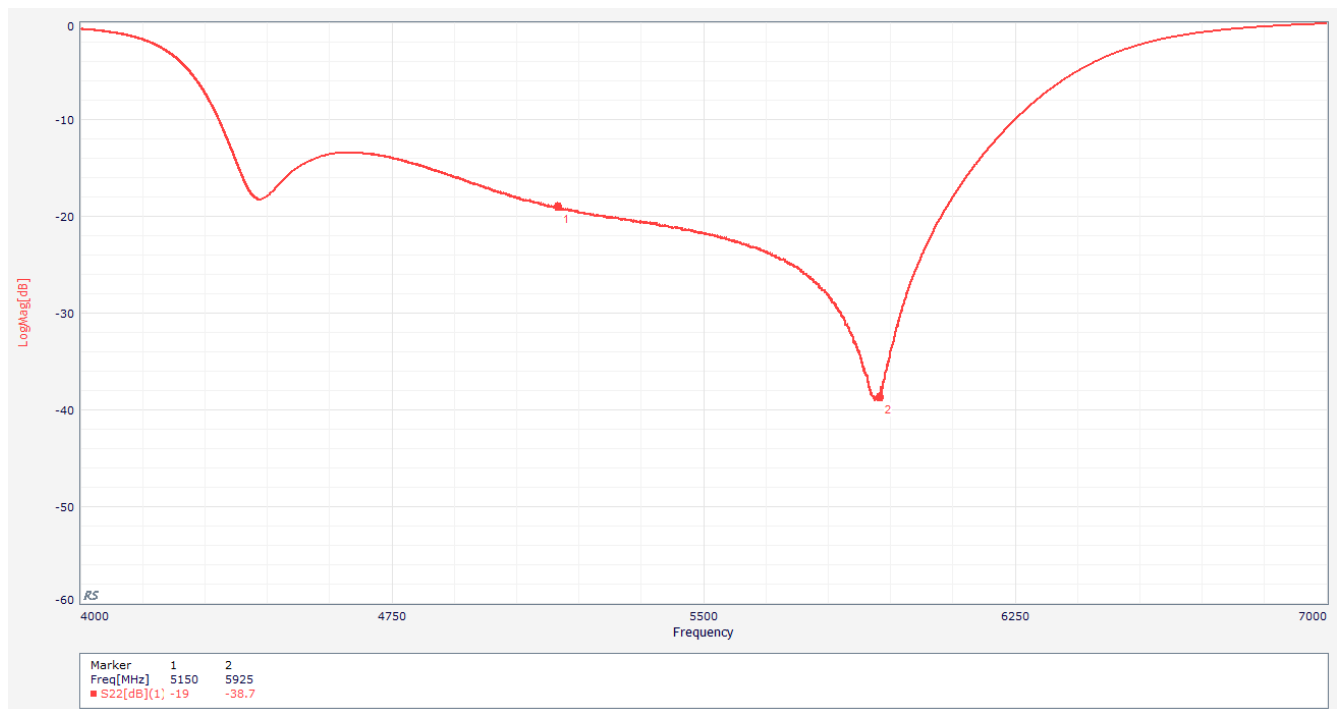

Package Dimensions

E. Package Dimensions:

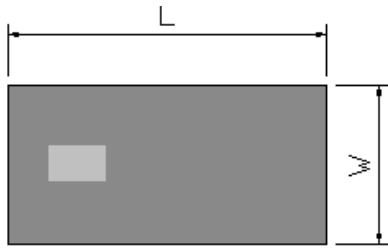

Top View

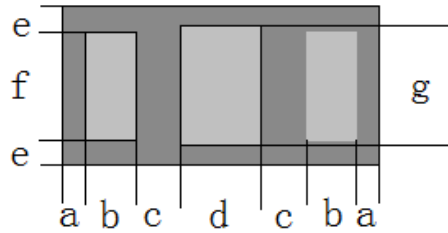

Bottom View



Side View

Mark	L	W	T	a	b	c	d	e	f	g
Dimensions	1.6±0.2	0.8±0.2	0.6±0.1	0.12±0.1	0.25±0.1	0.23±0.1	0.4±0.1	0.125±0.1	0.55±0.1	0.6±0.1

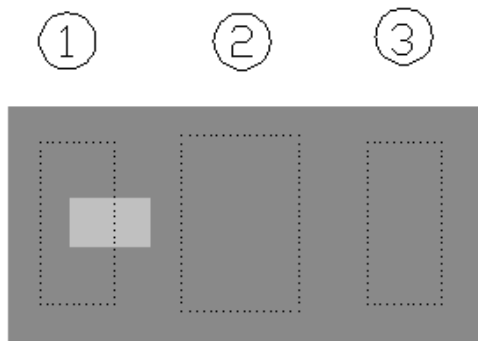

Number	Terminal Name
①	IN
②	GND
③	OUT

Recommended Footprint (PCB Layout)

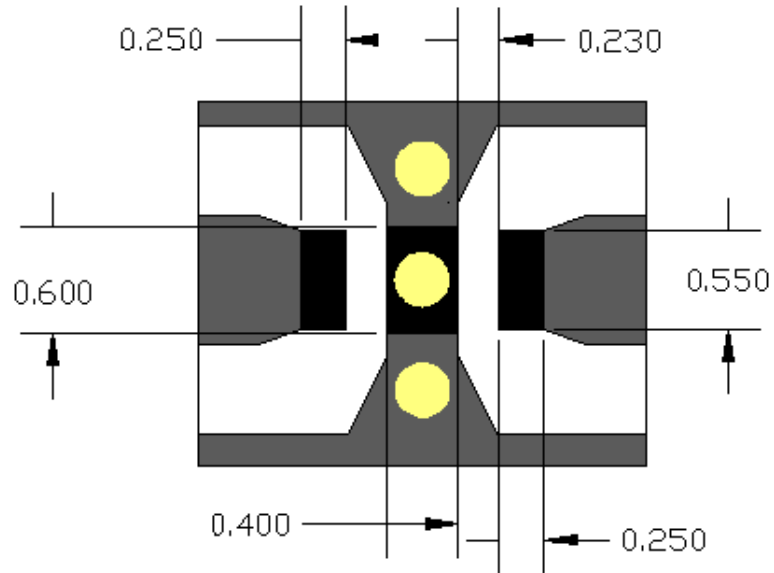

- | | |
|---|--|
|  Solder resist |  No pattern Solder resist |
|  Land |  Through hole |

Tape and Reel Specifications

Tape and Reel Standard per ANSI/EIA-481

Reel Dimensions – 7" = 4000

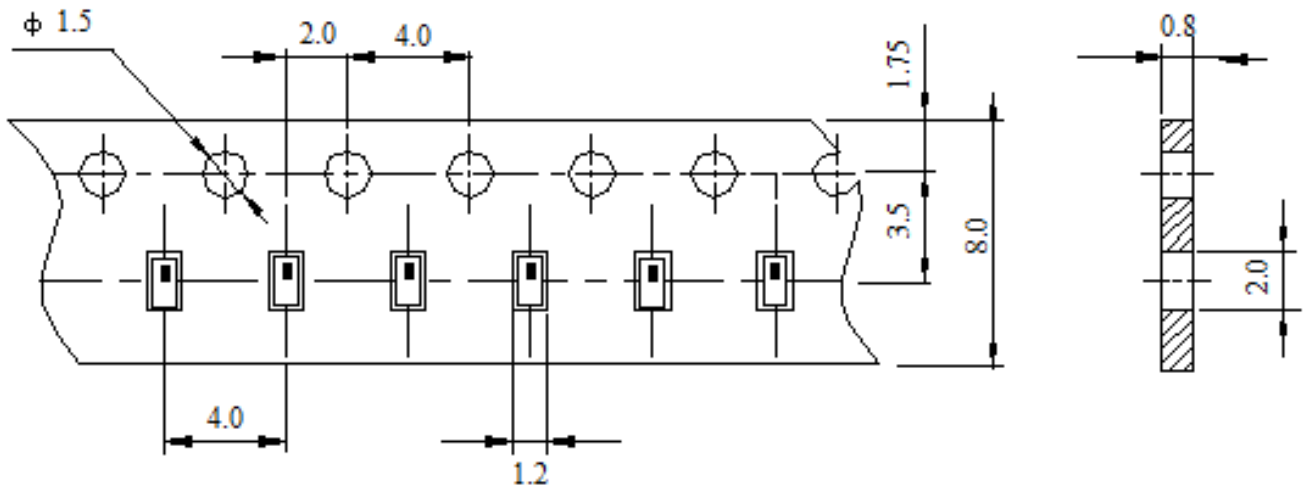
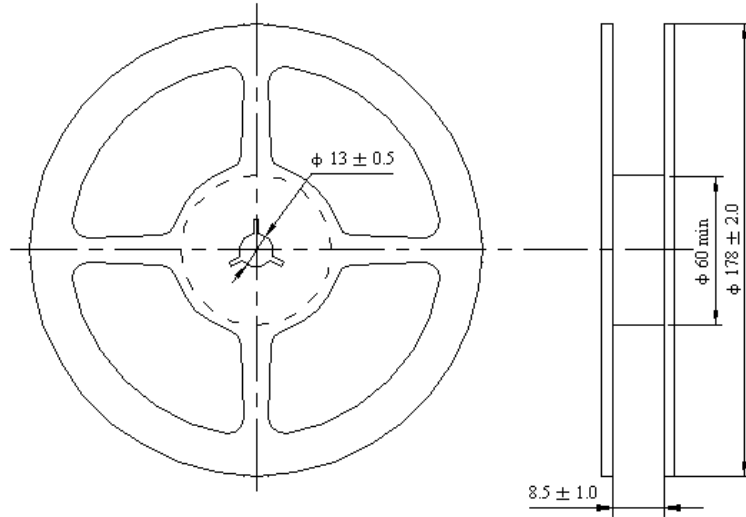

Recommended Reflow Profile

1. Preheating shall be fixed at 150~180°C for 60~90 seconds.
2. Ascending time to preheating temperature 150°C shall be 30 seconds min.
3. Heating shall be fixed at 220°C for 50~80 seconds and at 260°C +0/-5°C peak (10 seconds).
4. Time: 5 times maximum.

