

SF2530LA

**1842.500 MHz
SAW Filter**



SM1109

MAXIMUM RATING:

1. Operating temperature range: -40 °C to +85 °C
2. Storage temperature range: -40 °C to +100 °C
3. Maximum Input Power: +10 dBm
4. Maximum DC Voltage: +/-5 V
5. Moisture Sensitivity Level: Level 1
6. ESD 50V(MM) 100V(HBM)
7. AEC-Q200 Qualified

ELECTRICAL CHARACTERISTICS:

Terminating source impedance: $Z_s = 50//33nH \Omega$ (Single-ended)

Terminating load impedance: $Z_L = 50//12nH \Omega$ (Single-ended)

Parameters Description			Unit	Min.	Typ.	Max.
Center Frequency			MHz	-	1842.5	-
Insertion Loss(*1)		1805~1880 MHz	dB	-	2.0	4.0
Amplitude Ripple		1805~1880 MHz	dB	-	-	3.3
VSWR	Input	1805~1880 MHz	-	-	1.9	2.3
	Output	1805~1880 MHz	-	-	1.8	2.2
Attenuation:						
DC~960 MHz			dB	34	37	-
1558~1608 MHz			dB	35	41	-
1710~1785 MHz			dB	34	38	-
1920~2400 MHz			dB	25	35	-
2400~2500 MHz			dB	33	44	-
2500~3610 MHz			dB	25	36	-
3610~3760 MHz			dB	25	36	-
3760~5415 MHz			dB	20	29	-
5415~5640 MHz			dB	20	29	-
5640~7220 MHz			dB	18	24	-
7220~7520 MHz			dB	16	24	-
7520~8000 MHz			dB	14	22	-

(*1) Specification of insertion loss excludes loss that comes from the test board.



CAUTION: Electrostatic Sensitive Device. Observe precautions for handling.

1. The design, manufacturing process, and specifications of this device are subject to change.
2. US or International patents may apply.
3. RoHS compliant from the first date of manufacture.

FREQUENCY CHARACTERISTICS:

Frequency Response

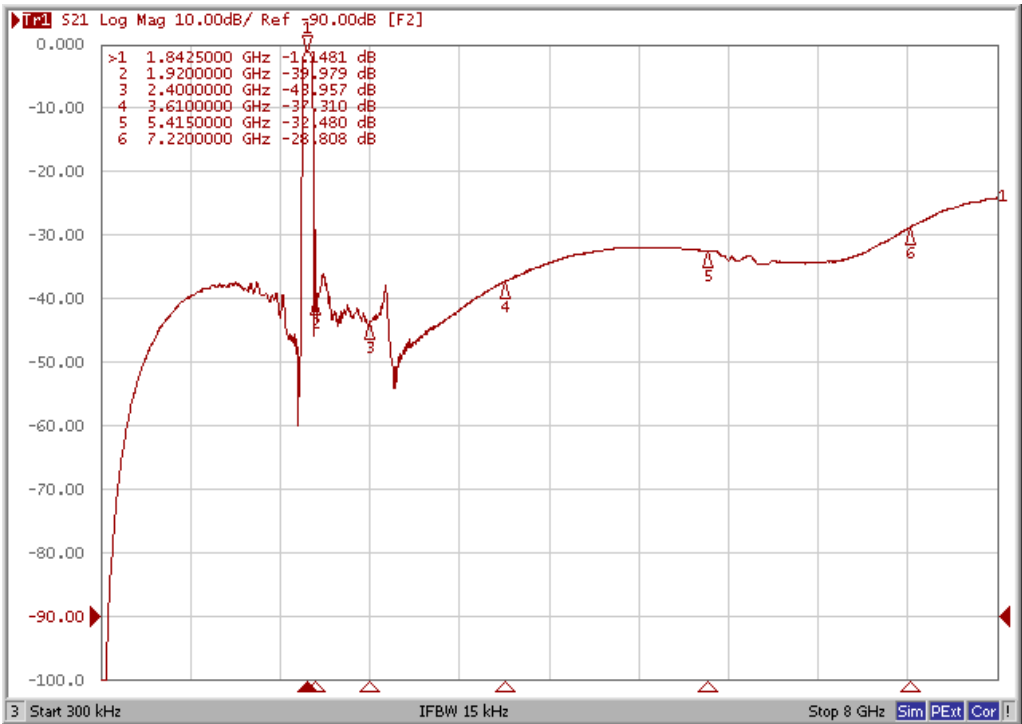
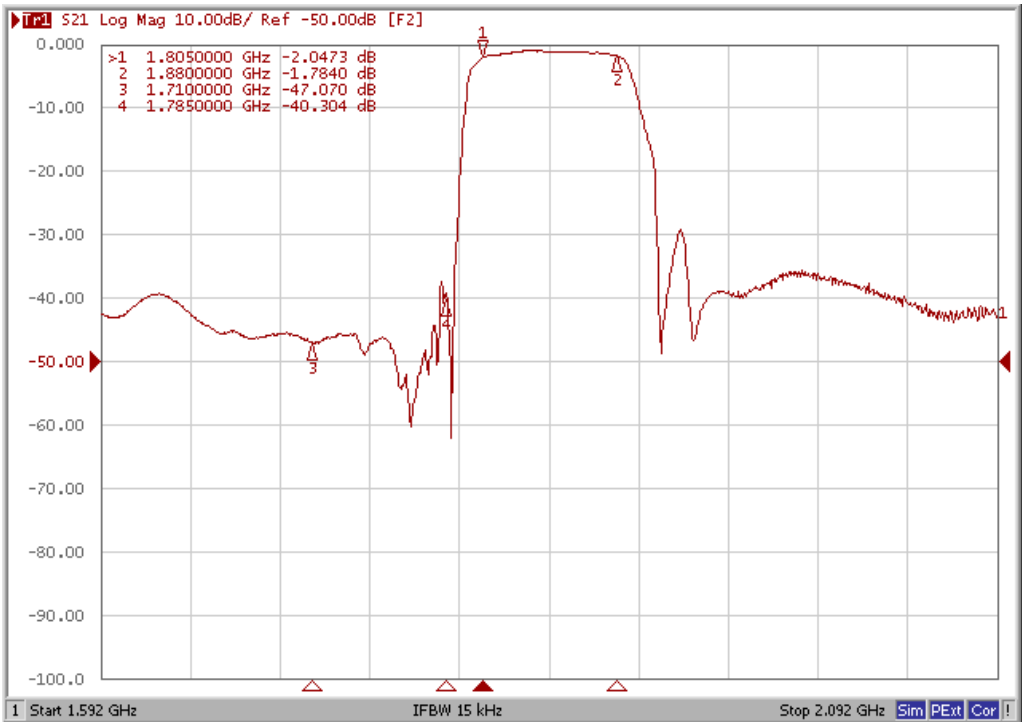

Ripple

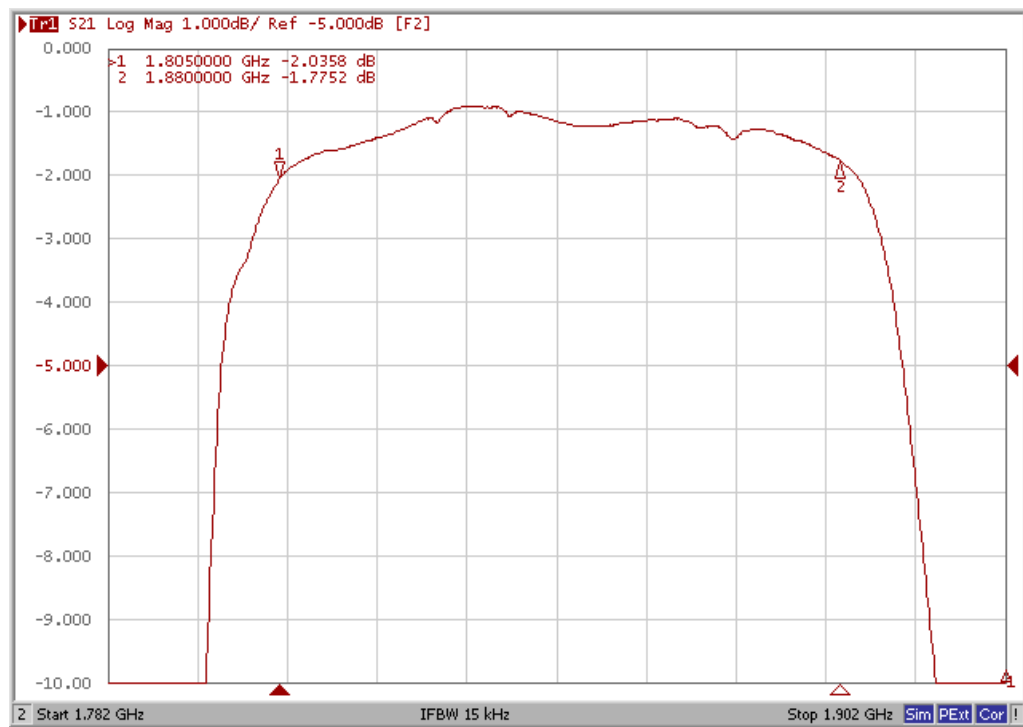

VSWR (S11)

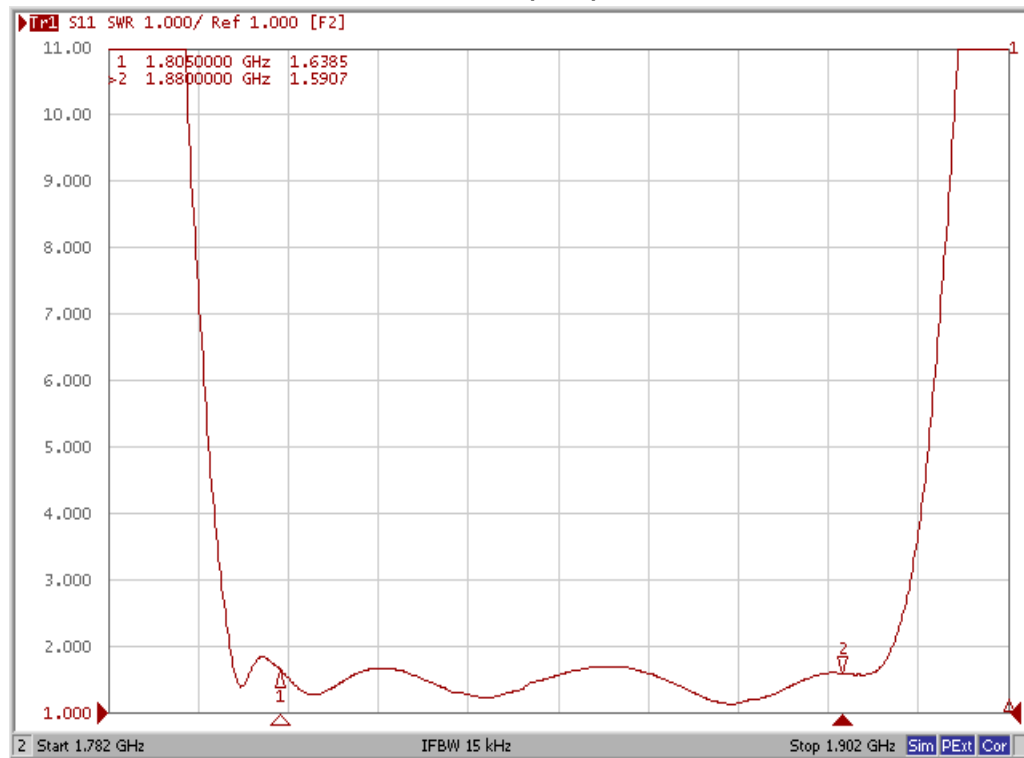

VSWR (S22)

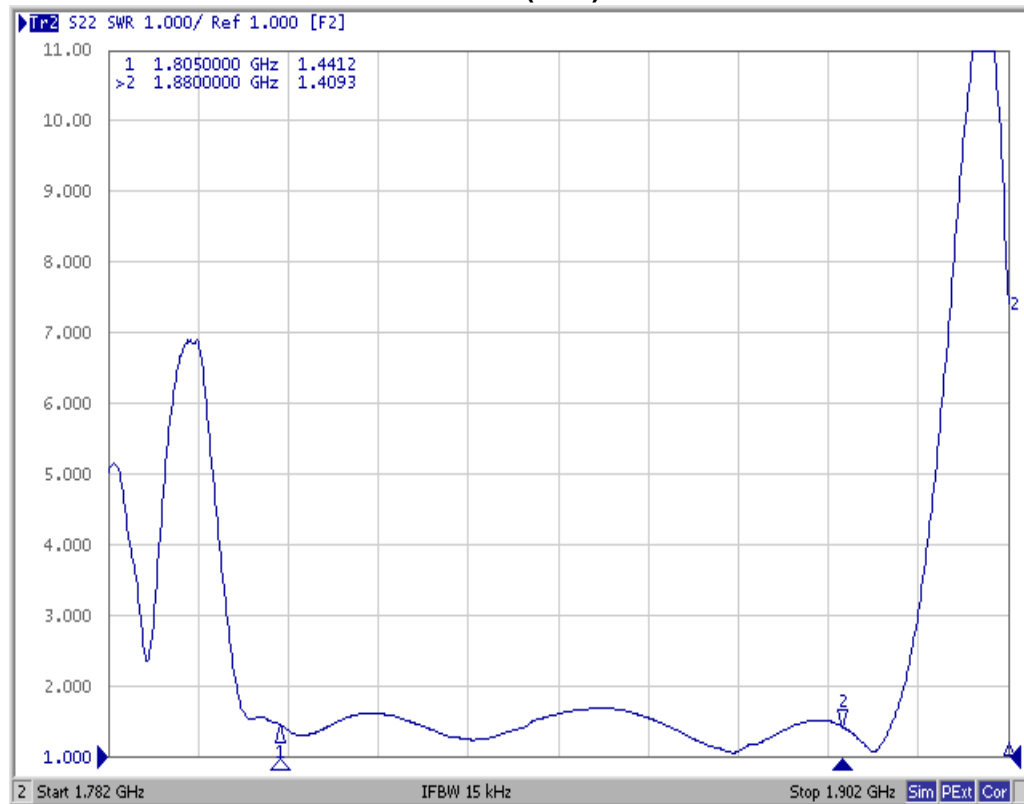

Smith Chart (S11)

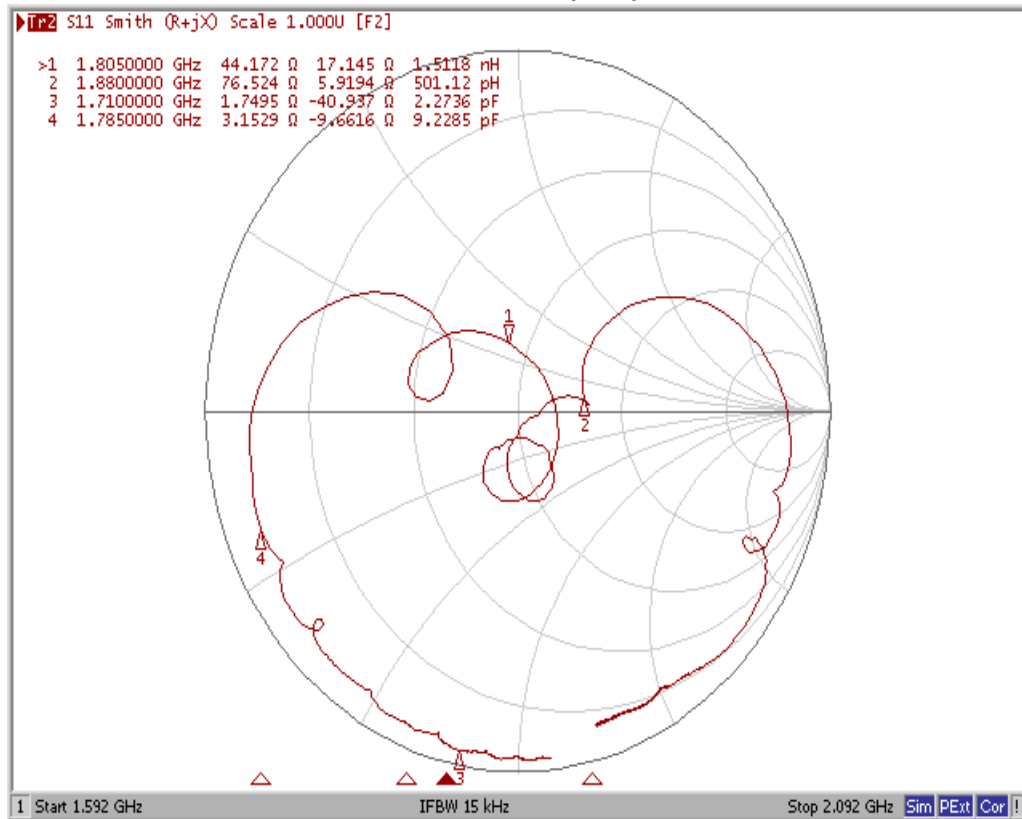

Smith Chart (S22)

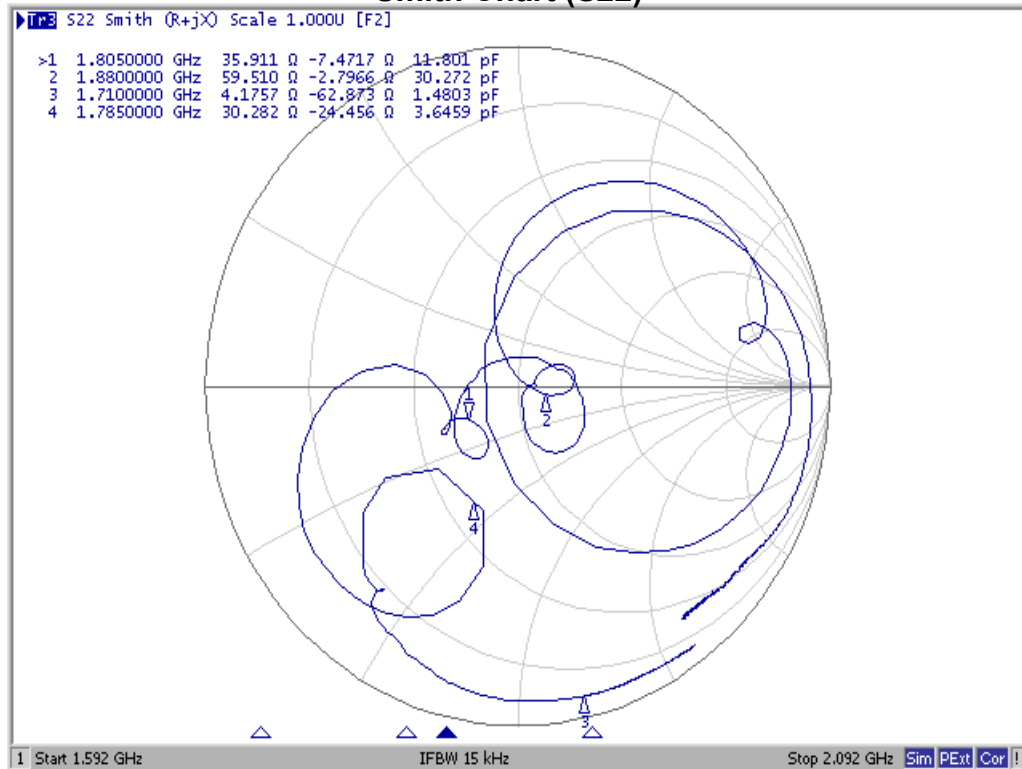

MEASUREMENT CIRCUIT:

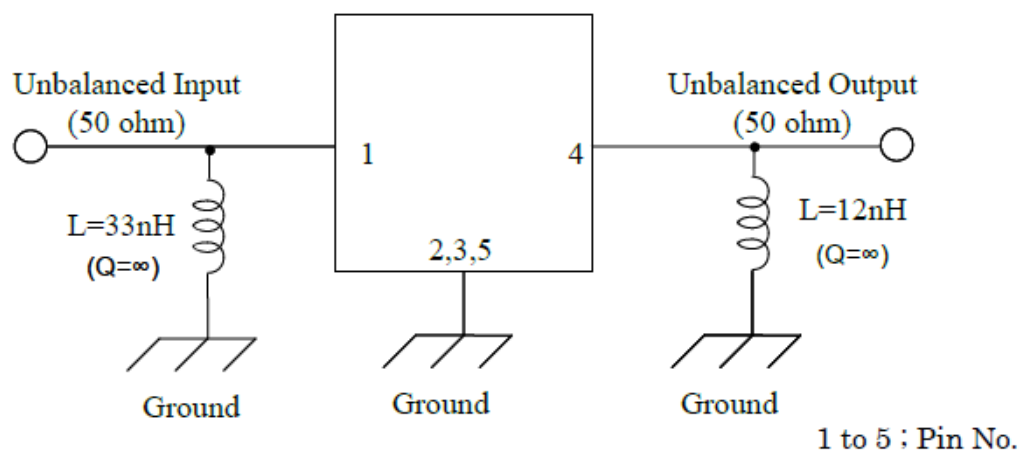

OUTLINE DRAWING:

Device size: 1.1typ. x 0.9typ. x 0.5max.

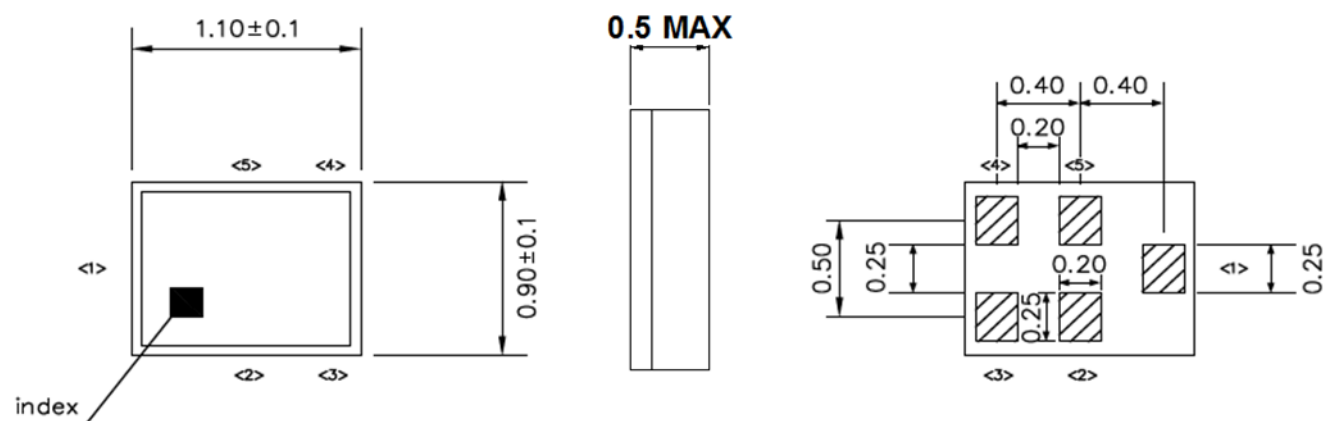

Pin Configuration

Pin No.	Symbol	Function
1	IN	Unbalanced pin
2	GND	Ground
3	GND	Ground
4	OUT	Unbalanced pin
5	GND	Ground

Top View (Sample Production):

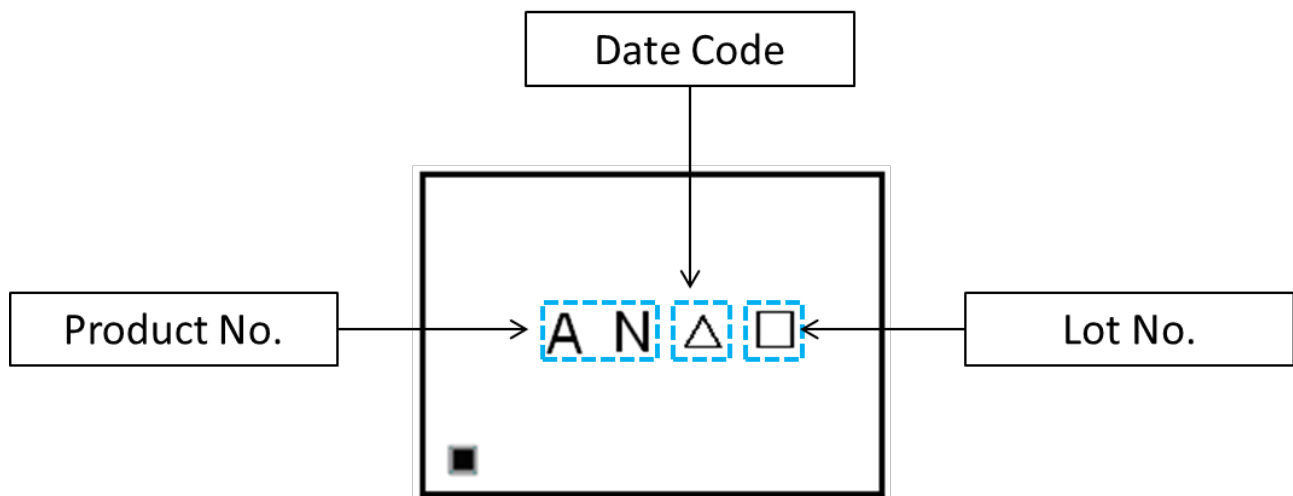

Top View (Mass Production):

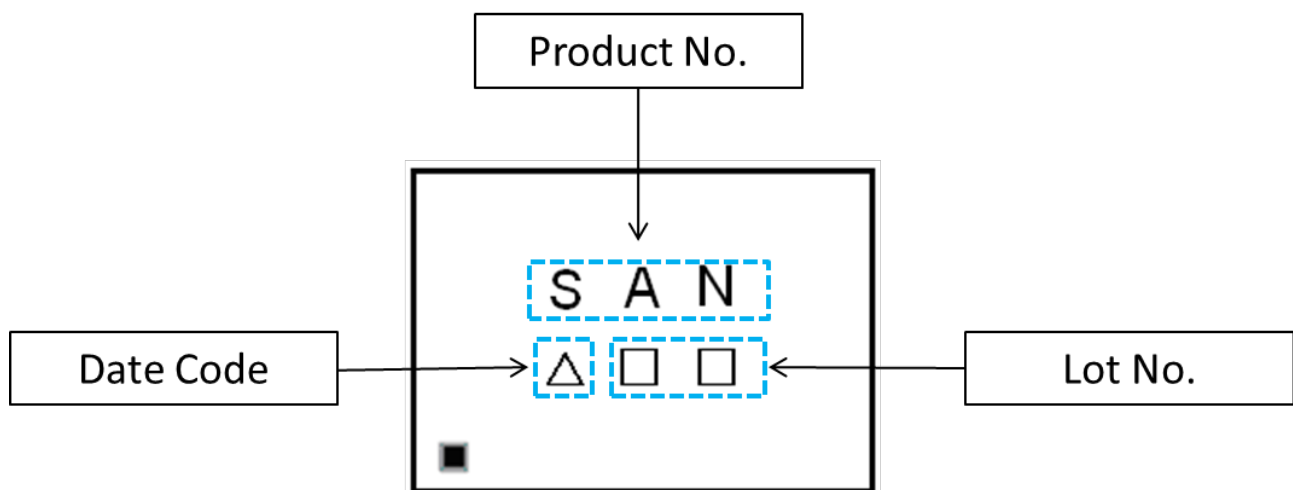

△ : Date Code

□ : Lot No. (Indicated by 0~9 or A to Z and a to z, except I, O, i, o and l)

Product date Code (EIAJ)

Year	Jan	Feb	Mar	Apr	May	Jun	Jul	Aug	Sep	Oct	Nov	Dec
2015	a	b	c	d	e	f	g	h	j	k	l	m
2016	n	p	q	r	s	t	u	v	w	x	y	z
2017	A	B	C	D	E	F	G	H	J	K	L	M
2018	N	P	Q	R	S	T	U	V	W	X	Y	Z

PACKING:

1. REEL DIMENSION

Reel Count:

7" = 5000

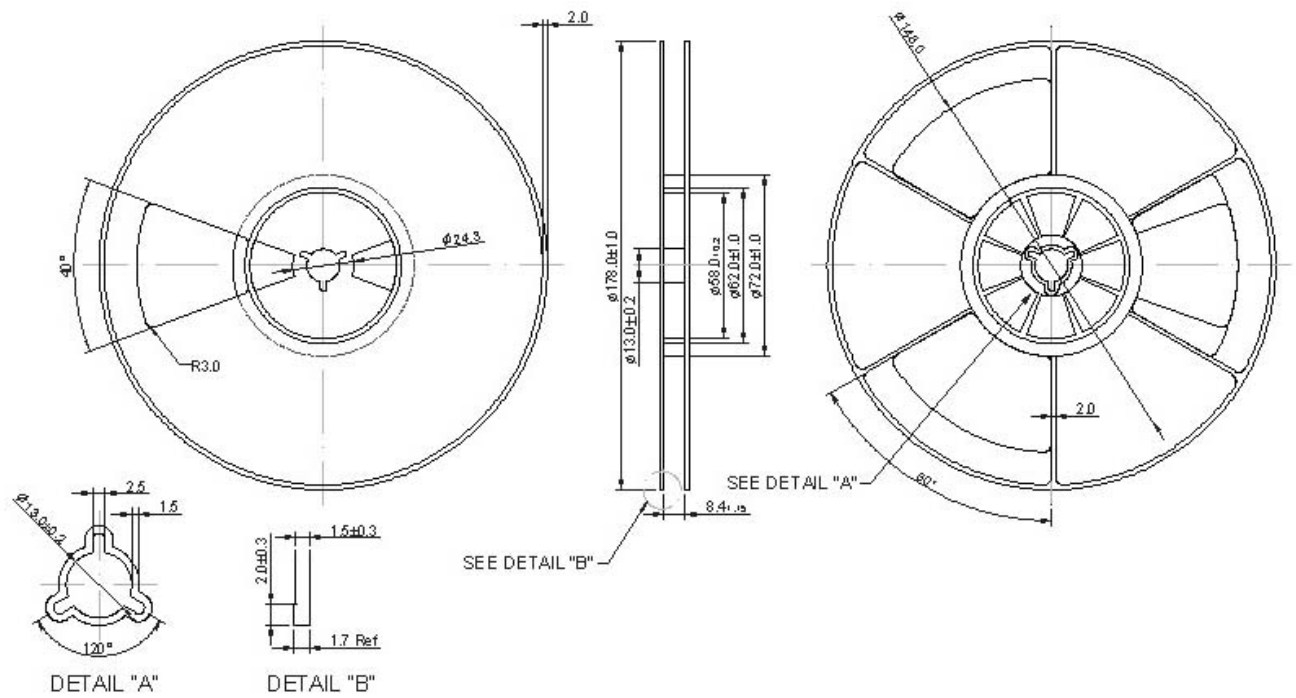

2. TAPE DIMENSION

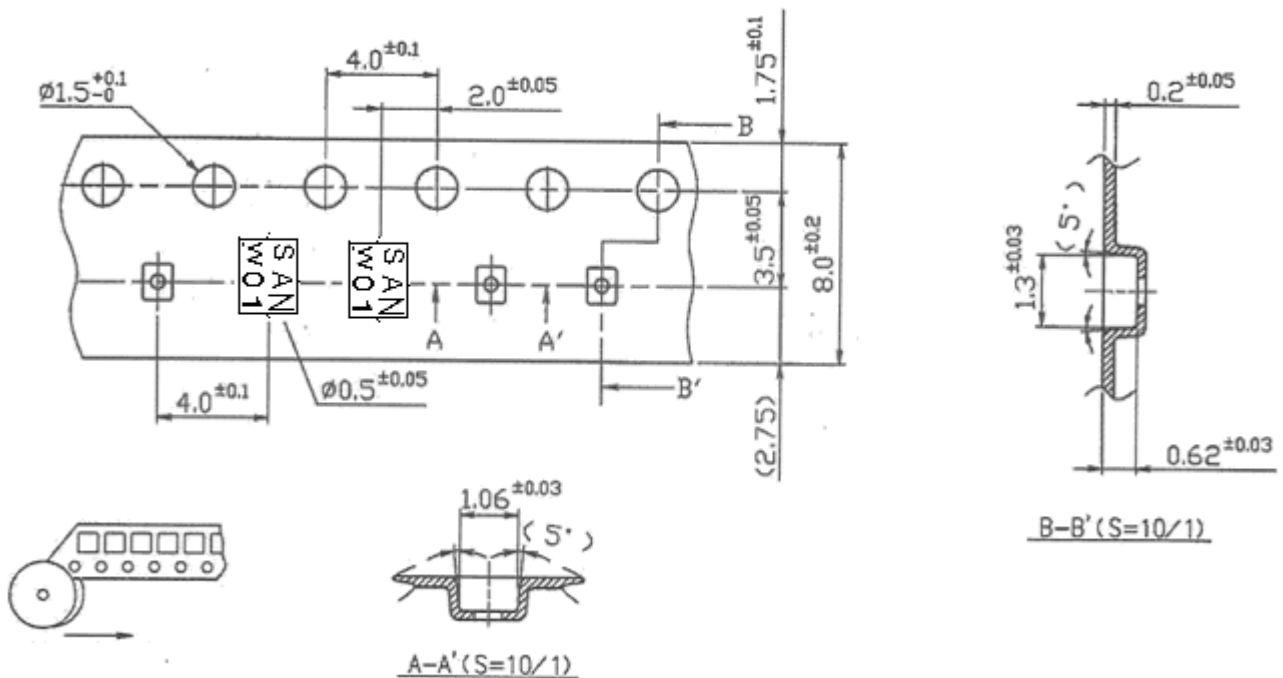

RECOMMENDED REFLOW PROFILE:

1. Preheating shall be fixed at 150~180°C for 60~90 seconds.
2. Ascending time to preheating temperature 150°C shall be 30 seconds min.
3. Heating shall be fixed at 220°C for 50~80 seconds and at 260°C+0/-5°C peak (20~40sec).
4. Time: 2 times.

